

NOT FOR CONSTRUCTION

It is a violation of New York Education Law Article 145, Section 7209, for any person who is not a duly licensed professional engineer, professional architect, professional engineer, or land surveyor, to alter in any way, or an item bearing the seal of an architect, engineer, or land surveyor is altered, the altering architect, engineer, or land surveyor shall affix to the item their seal and notation, altered by, followed by their signature and date, and a specific description of the alteration.

© 2020 LaBella Associates

NORBUT SOLAR FARMS
1241 UNIVERSITY AVE.
ROCHESTER, NY 14607



ENFIELD SOLAR DEVELOPMENT
56 APPLGATE RD. S
ENFIELD, NY 14850

ID	DATE	DESCRIPTION
Revisions		

PROJECT NUMBER: 2203009

DRAWN BY: BER

REVIEWED BY: JT

ISSUED FOR: REVIEW

DATE: NOVEMBER 2020

DRAWING NAME:

OVERALL EXISTING CONDITIONS

DRAWING NUMBER:

C100

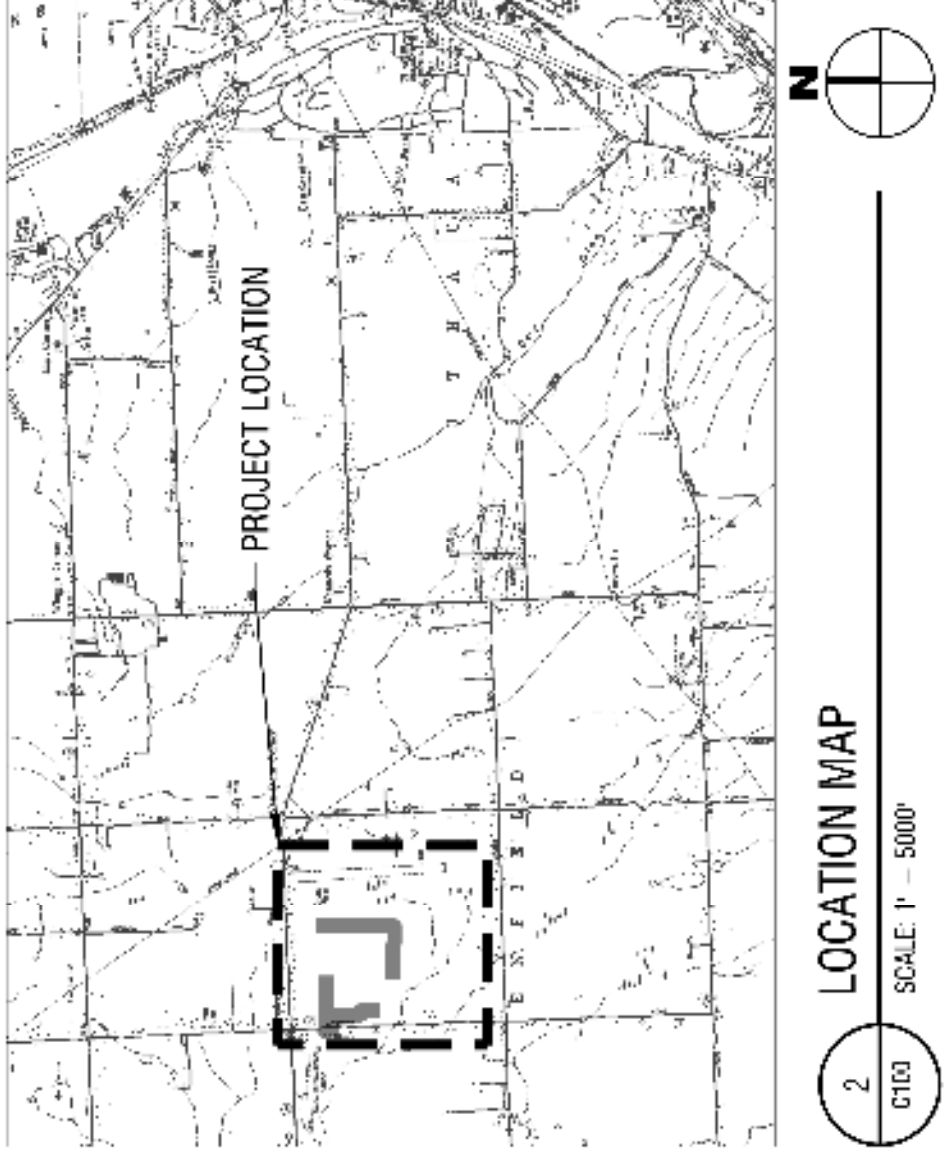

LEGEND

EXISTING	PROPOSED	DESCRIPTION
		WETLAND
		ROADWAY CENTERLINE
		PERMANENT GRAVEL PAVEMENT
		CHAIN LINK FENCE
		TREELINE
		BUILDING FOOTPRINT
		PROPERTY LINE
		SETBACK LINE
		OVERHEAD ELECTRIC LINE
		UNDERGROUND ELECTRIC LINE
		MANHOLE
		AMBUSH CONTOUR
		UTILITY POLE 6'-10" HGT

PROJECT DATA

PARCEL INFORMATION

APPLICANT	NORBUT SOLAR FARMS
PROPERTY ADDRESS	UNADPRESSED PERCIBATE ROAD ENFIELD, NY 14850
TAX NUMBER	9-1-281.9-1-27.9-1-1*
PROJECT AREA	30.06 ACRES
EXISTING IMPERVIOUS WITHIN PROJECT AREA	BUILDINGS 375 SF GRAVE 0.242 SF TOTAL 0.008 AC
PROPOSED IMPERVIOUS WITHIN PROJECT AREA	SUM 30000 0 SF CONCRETE 2,817 SF REG GRAVEL DRIVE 0 SF TOTAL 0.15 AC
PANEL COVERAGE	33.07 ACRES
TOTAL TEMPORARY DISTURBANCE AREA	33.06 ACRES

WETLAND INFORMATION

WETLANDS WITHIN PROJECT AREA	EXISTING	PROPOSED
	15.74 ACRES	15.74 ACRES

ZONING INFORMATION

FRONT SETBACK	REQUIRED	PROPOSED
	--	= 700 FT
SIDE SETBACK	REQUIRED	PROPOSED
	--	= 1200 FT
REAR SETBACK	REQUIRED	PROPOSED
	--	= 600 FT

